

N N 2W.WN3

The Courses & Distances  
down little Juniatta  
from the W.O. to the B.O.K.

- N 82 E 19 p<sup>s</sup>
  - S 54 E 29
  - S 36 E 20
  - S 12 E 29
  - South — 36
  - S 25 E 15
  - S 14 W 66
  - South — 54
  - S 67 E 20
  - S 75 E 34
  - S 84 E 35
  - S 64 E 24
  - S 42 E 20
  - S 28 E 42
  - S 43 E 35
  - S 51 E 20
  - S 71 E 16 to the B.O.K.
- 534 perches.

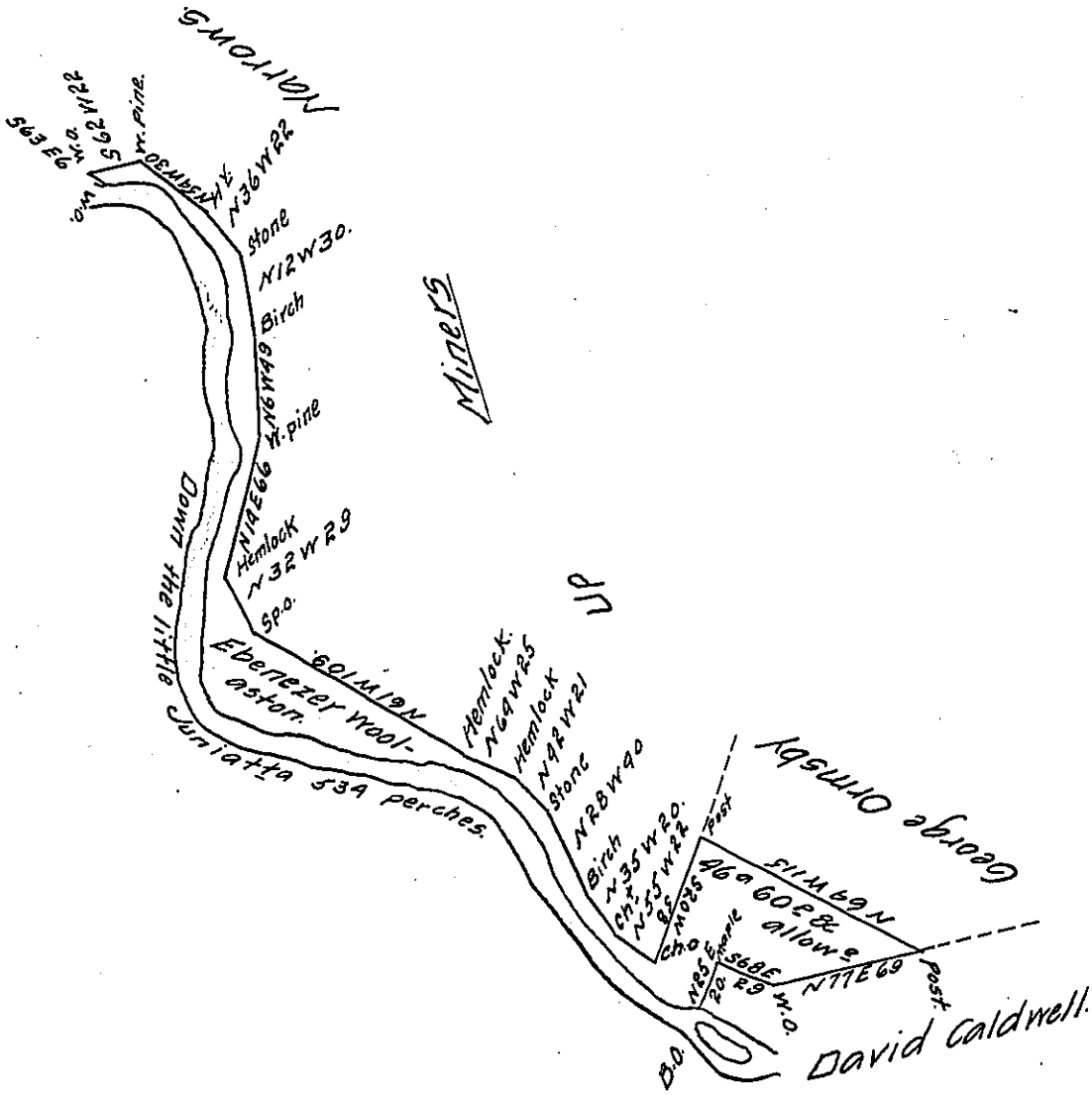

Situate on the East side of little Juniatta including  
Minors Narrows in the Townships of Barree and Franklin and  
County of Huntingdon Containing Forty Six Acres Sixty  
perches and the usual allowance of Six p<sup>r</sup> Ct for Roads &c  
Surveyed the Twenty second day of May 1794 In pursuance  
of a Warrant Dated the Eleventh day of June 1792 Granted  
to Ebenezer Woolaston for 50 Acres.

John Canan D.S.

Daniel Brodhead Esquire S.G.

IN TESTIMONY that the above is a copy of the original remaining on file in  
the Department of Internal Affairs of Pennsylvania, made  
comformably to an Act of Assembly approved the 16th day of  
February 1833, I have hereunto set my hand and caused  
the Seal of said Department to be affixed at Harrisburg,  
this twenty first day of May 1907.

*Henry Howell*  
Secretary of Internal Affairs.